

# The Best Is Now The Easiest

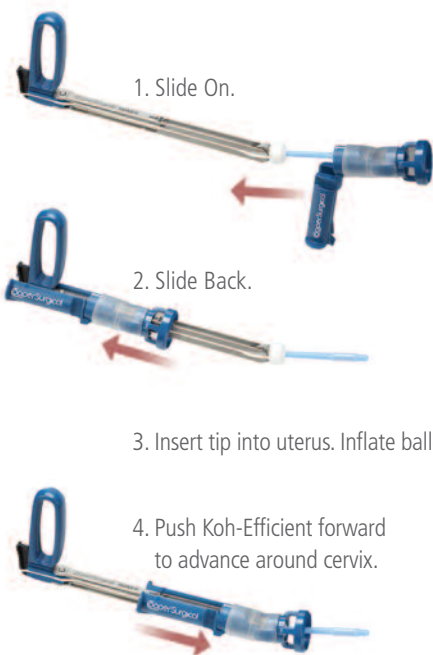

## RUMI® II SYSTEM

### Engineered With Our New Easy Load Design

#### Always the Best:

- Superior strength – Metal construction ensures better durability and tactile feedback
- Precise control – 140° of articulation at the cervix, with locking handle
- Safer surgery – Multiple tip and KOH Cup™ sizes provide unparalleled delineation of the fornix

#### Now the Easiest:

- Faster set up – Integrated KOH Cup and pre-attached occluder balloon facilitates assembly
- Easier insertion – Easy load design permits insertion under direct visualization
- Better visibility – Koh-Efficient™ slides forward to securely lock cup in place around the cervix
- Longer length – Accommodates larger patients
- Single-use cup – Sterile, accurate and stable cutting surface for each surgery

During TLH procedures, the Koh-Efficient creates a 'margin of safety' by providing a visual landmark and backstop for full circumferential colpotomy, as well as distancing the ureters during the incision. Vaginal length is maximized and pneumoperitoneum is maintained.



RUMI II is engineered with our easy load system making it simple and easy to insert. Scan. Watch. Learn. or go to [coopersurgical.com/RUMI](http://coopersurgical.com/RUMI)

**CooperSurgical**

## Achieve Superior Control and Ideal Visualization with the Redesigned RUMI® II System

- 2 inch longer shaft for better access
- New tips to accommodate varying patient anatomy
- Sacrocolpopexy and Sacrocervicopexy tips
- New Koh-Efficient™ for easier, faster, safer TLHs
- Improved placement of KOH Cup™ around cervix
- Cervical Sizer to ensure the right Koh-Efficient fit
- Catheter management system

## RUMI and RUMI II System Compatibility

- RUMI tips are compatible with all RUMI handles including RUMI, RUMI II, RUMI Arch®
- The RUMI II Koh-Efficient systems are unique to the RUMI II Uterine Manipulator
- The UPS has three reusable adaptors – one each that is specific to the RUMI, RUMI II, RUMI Arch
- The original KOH Cup and Colpo-Pneumo Occluder™ system can be used with the RUMI II

## The Koh Efficient™ Creates a Margin of Safety by Providing a Visual Land Mark and Back Stop for Full Circumferential Colpotomy

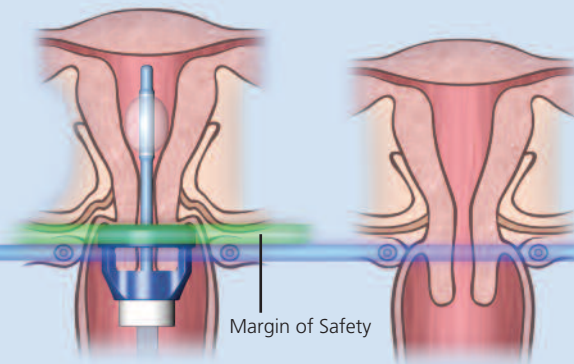

## Ordering Information

Code	Product	Description
<b>Uterine Manipulator</b>		
UMH650	RUMI II Handle	(1 each)
<b>RUMI Tips</b>		
UMY514	RUMI Tip Yellow	5.1 mm x 3.75 cm (5 per box)
UML516	RUMI Tip Lavender	5.1 mm x 6 cm (5 per box)
UMW676	RUMI Tip White	6.7 mm x 6 cm (5 per box)
UMB678	RUMI Tip Blue	6.7 mm x 8 cm (5 per box)
UMG670	RUMI Tip Green	6.7 mm x 10 cm (5 per box)
UMO672	RUMI Tip Orange	6.7 mm x 12 cm (5 per box)
SACRO-1	Sacrocolpopexy Tip - Large	(3 per box)
SACRO-1S	Sacrocolpopexy Tip - Small	(3 per box)
SACRO-1C	Sacrocervicopexy Tip - Concave Distal End	(3 per box)
<b>Cervical Sizer</b>		
KC-SIZER	Cervical Sizer	(1 each)
<b>RUMI II Koh-Efficient System</b>		
KC-RUMI-25	RUMI II / Koh-Efficient	2.5 cm (5 per box)
KC-RUMI-30	RUMI II / Koh-Efficient	3.0 cm (5 per box)
KC-RUMI-35	RUMI II / Koh-Efficient	3.5 cm (5 per box)
KC-RUMI-40	RUMI II / Koh-Efficient	4.0 cm (5 per box)
<b>Uterine Positioning System™</b>		
371550-03	Uterine Positioning System	
53468	Adapter, RUMI II, UPS	
400245-01	Drape, UPS, 20/Case	
371560-01	Uterine Positioning System - Cart	

All RUMI Products are Latex Free

## CooperSurgical

CooperSurgical is the leading company dedicated to providing medical devices and procedure solutions that improve health care delivery to women regardless of clinical setting. Our company is fostering that position through expansion of its core businesses and introduction of advanced technology-based products, which aid clinicians in the management and treatment of commonly seen conditions.

To schedule a demonstration or trial of the RUMI II System, call 800.243.2974 or 203.601.5200. Visit [coopersurgical.com](http://coopersurgical.com) or see us at [youtube.com/coopersurgical](http://youtube.com/coopersurgical)

203.601.5200 | [coopersurgical.com](http://coopersurgical.com) | 95 Corporate Drive | Trumbull, CT 06611