



F9 Trolley

(For Medical Use)

Model MT-803

REF MS9-107634

Assembly Instructions



Major Parts

Upper Tray and Upper
Stand Post Groupware

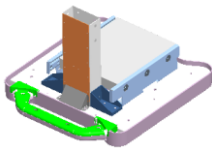

Cable Reels



Chassis



Lower Tray Groupware

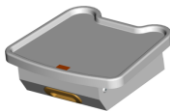

Lower Stand Post



Tablet (Optional)



Basket (Optional)



Fixed Board (Optional)



Support Bracket
(Optional)



Cable Clamp
(Optional)

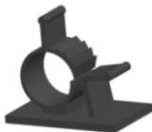

Accessories



1



2



3



4



5



6

F9 Trolley (Model MT-803) Assembly Instructions

No.	Name	Qty	Standby
1	M3x64 Locking Screw	2	/
2	M5X18 Screw, spring washer and plain washer groupware	15	2
3	M5X10 countersunk screw	8	2
4	M3X10 Screw, spring washer and plain washer groupware	10	1
5	M4 X12 Screw, spring washer and plain washer groupware	5	2
6	M4 X16 Screw, spring washer and plain washer groupware	6	2
7	M6X20 Hand Screw (Optional)	2	/
8	Cable Clamp (Optional)	2	1

WARNING

- 1) The assembling and disassembling of the trolley should be performed by service personnel authorized by the manufacturer.
- 2) The maximum load of the upper tray is 20KG. Do not put heavy objects on it or lean on it.
- 3) The maximum load of the lower tray groupware is 8KG (the drawer: 3KG; the tray: 5KG). Do not put heavy objects on it.
- 4) Perform safety check to the trolley at least every 24 months.
- 5) The maximum load of the paper container is 1.5KG.
- 6) The maximum load of the tablet is 0.5KG.
- 7) The maximum load of the support bracket is 3KG.

Exploded View of Trolley Packaging

Trolley parts are placed as shown in the diagram below. Please be careful when opening the package, and keep the parts so placed when repackaging them.

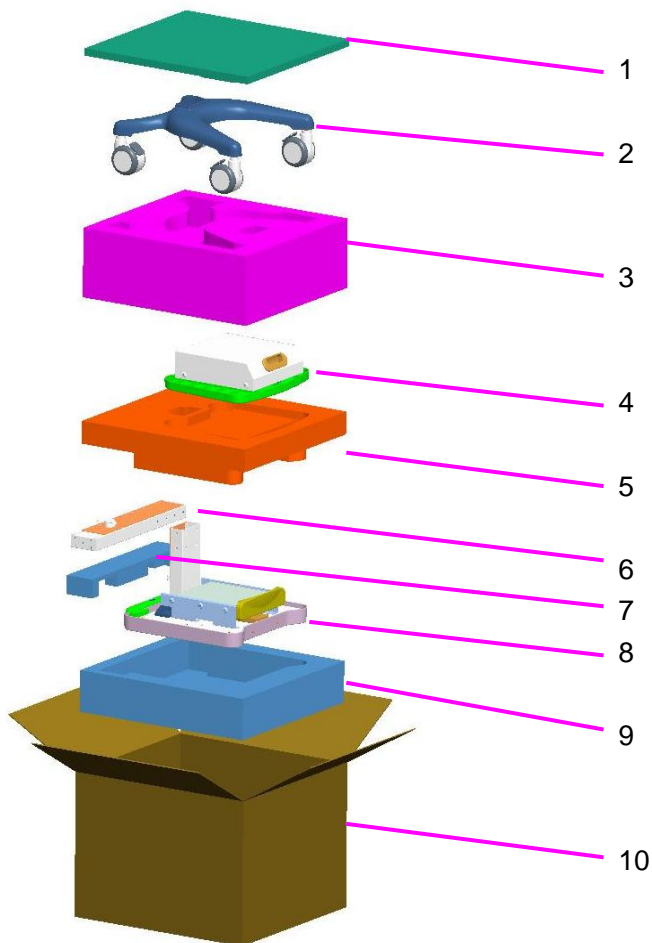

No.	Material
1	Packing foamy sponge (top)
2	Chassis
3	Packing foamy sponge (middle)
4	Lower tray groupware
5	Packing foamy sponge (middle)
6	Lower stand post
7	Movable foamy sponge
8	Upper tray and upper stand post groupware
9	Packing foamy sponge (bottom)
10	Packing box

Exploded View of Basket Packaging

Basket parts are placed as shown in the diagram below. Please be careful when opening the package, and keep the parts so placed when repackaging them.

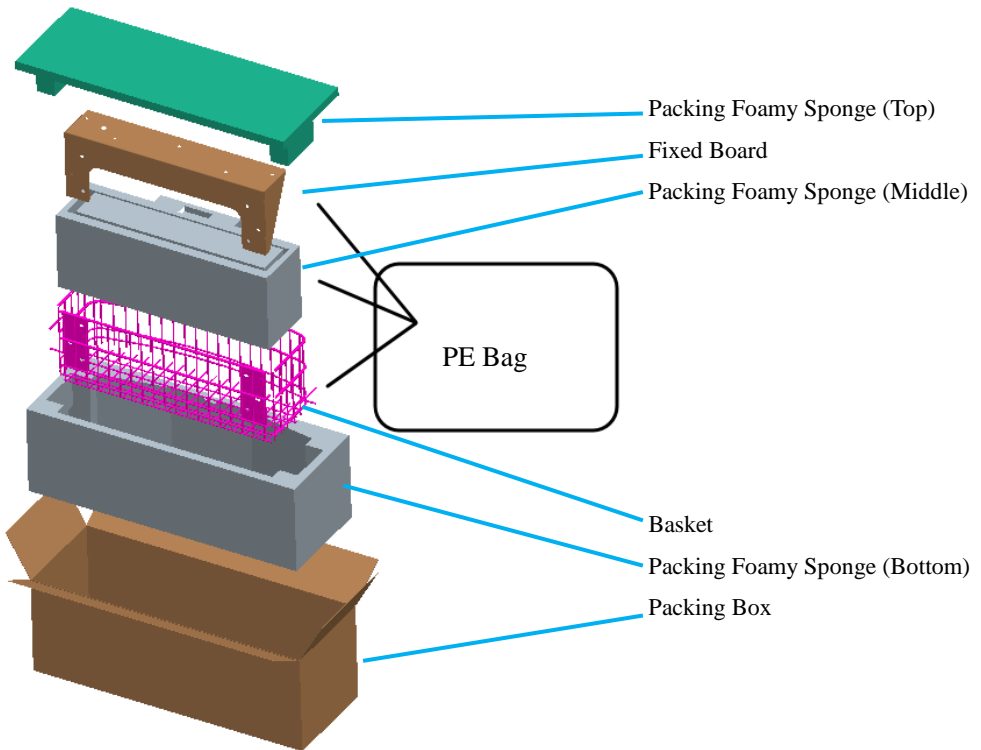

Exploded View of Support Bracket Packaging

Support bracket parts are placed as shown in the diagram below. Please be careful when opening the package, and keep the parts so placed when repackaging them.

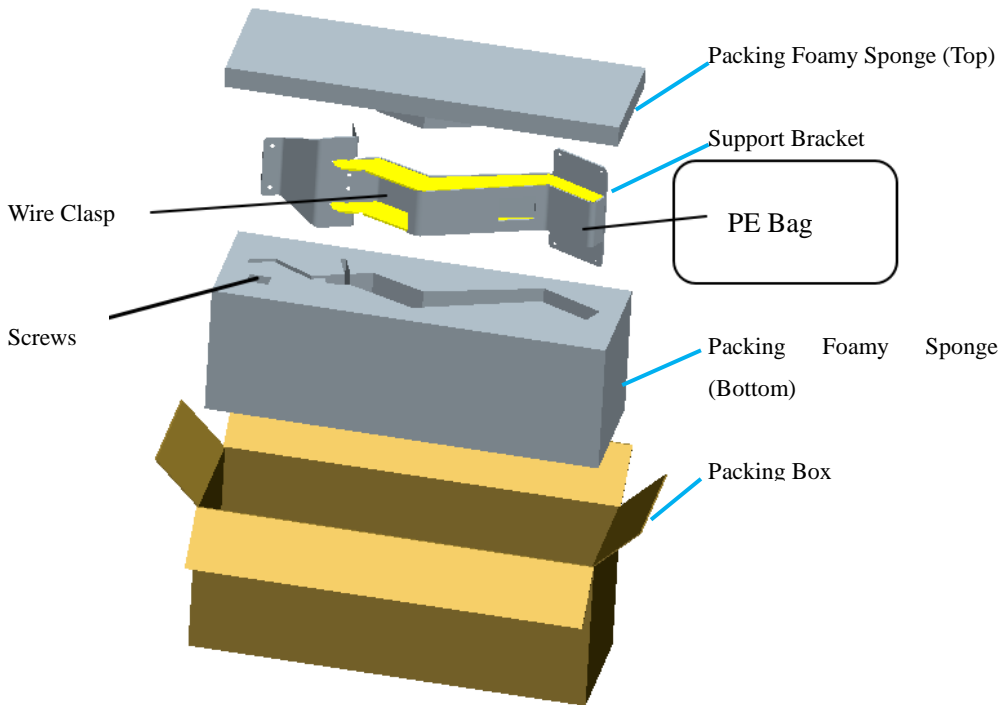

Assembling the Trolley

NOTE: Use a crosshead screw driver to secure all the screws tight when assembling the trolley.

- 1 Take out all the parts from the package and place them on the floor.

- 2 Insert the lower stand post into the quadrate hollow on the chassis, and secure the two parts with five M5X18 screws from the bottom up.

NOTE: The face of the stand post (the face with 12 holes) should be aligned with the face of the chassis (the face with long legs).

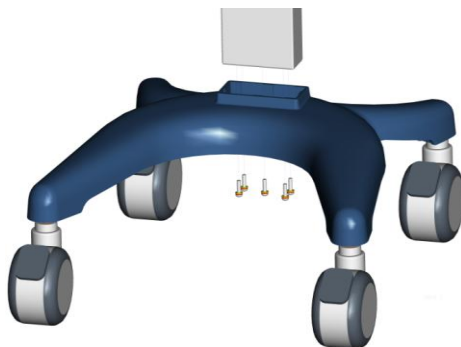

- 3 Remove the drawer of the lower tray groupware. Level the lower tray at the four lowest holes of the post and secure the two parts with six M5X18 screws from beneath the tray. Place the drawer back in position.

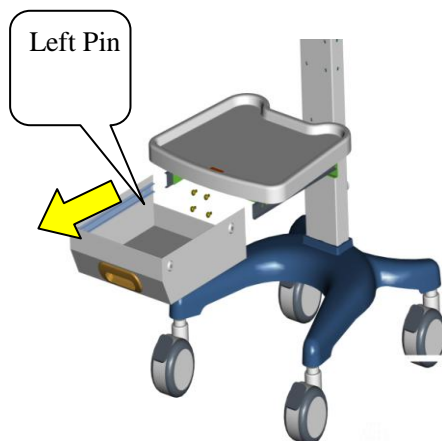

- 4 Align the two stand posts and slide the upper post to cover the lower post. Adjust the height as needed and secure the posts with eight M5X10 countersunk head screws from the face and both sides respectively.

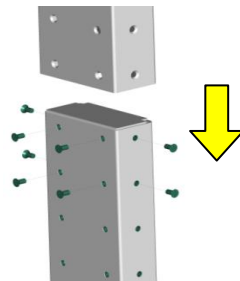

- 5 Align the cable reels with the holes on the rear of the posts and secure them with three M3X10 screws respectively.

NOTE: The reel on top should be fixed with its lugs facing up, and the bottom reel's lugs should face down.

- 6 Check and make sure all the parts are securely fixed.



The trolley assembling is completed.

Fixing the Monitor to the Trolley

WARNING

1. This trolley is intended to be used with F9/F6 Series Fetal & maternal Monitor only. Make sure the trolley is firmly assembled and is in good condition before applying the monitor to it.
2. The objects should be placed in the middle of the tray during transportation. Please support the trolley with your hand to prevent the trolley overturn when crossing the steps or slope.

1 Place the monitor on the upper tray with its four rubber feet fitting in the holes of the tray. Open the drawer. Push the two tightening bolts through the two holes of the tray crossbeam and the tray from the bottom up. Tighten the bolts with your fingers.

2 Check and make sure the monitor is securely fixed to the tray.

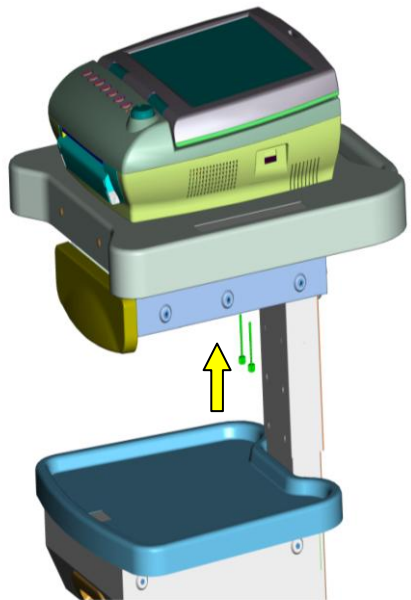

Installing the Tablet (Optional)

Remove the two silica gel nails from the upper tray, and level it with the tablet through the two holes. Then secure them using two M6X20 knobs.

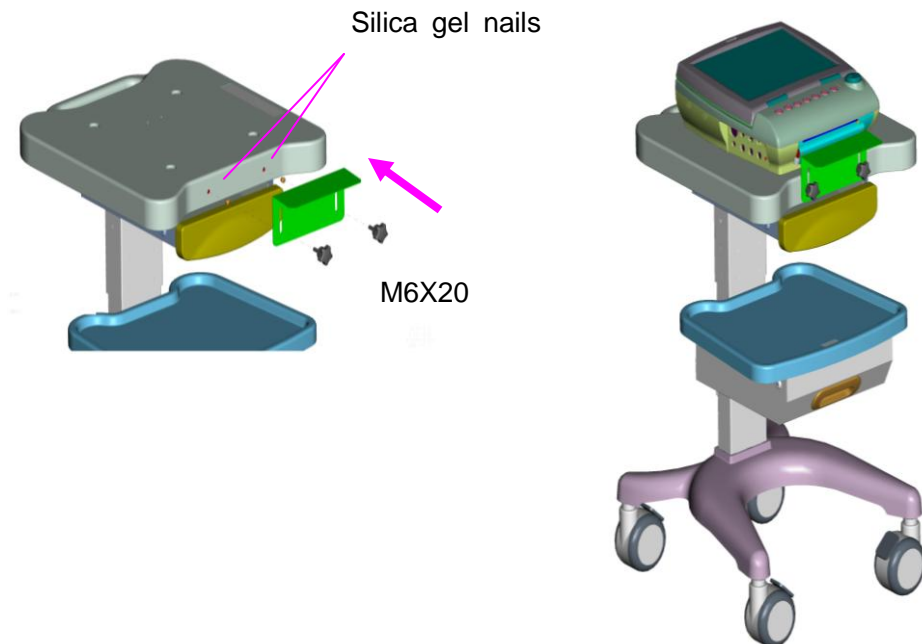

Note: Loosen the two screws before installing recorder paper, and secure them after installation.

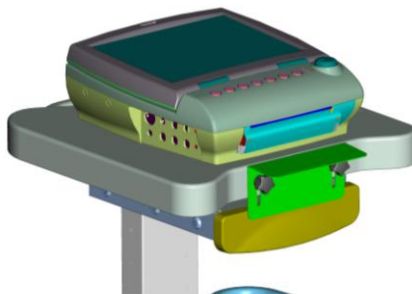

Installing the Basket (Optional)

- 1 Invert the trolley and unscrew three M4X12 screws in the upper tray. Install the fixed board on the upper tray with five M4X12 screws.

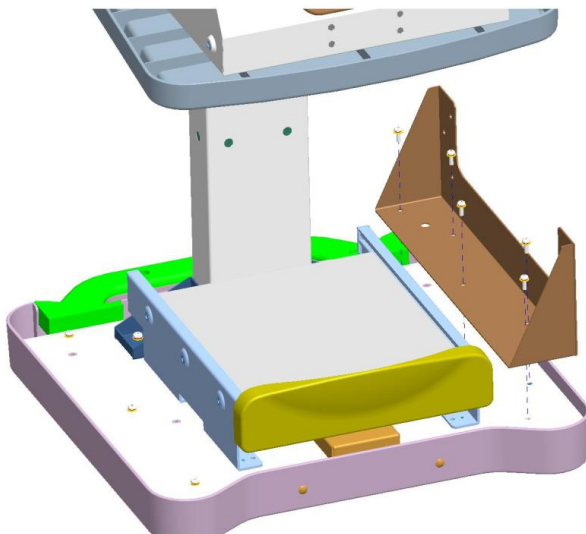

- 2 Fix the basket on the side of the upper tray with six M4X16 screws.

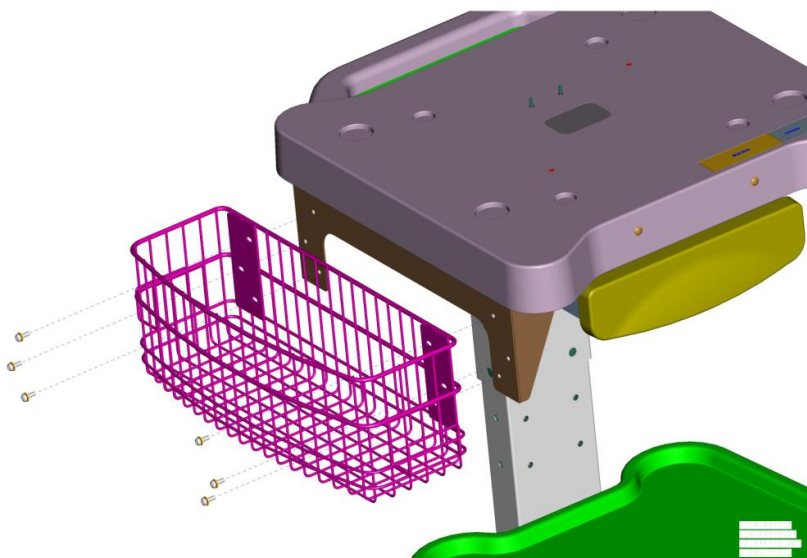

Note:

1. It is recommended that the basket should be installed on the left of the trolley.
2. The maximum load of the basket is 5KG. Do not put heavy objects on it.
3. The basket is installed.



Installing the Support Bracket (Optional)

1. Install the support bracket on the top of the upper tray and on the back of upper stand post with two M5X18 screws respectively.

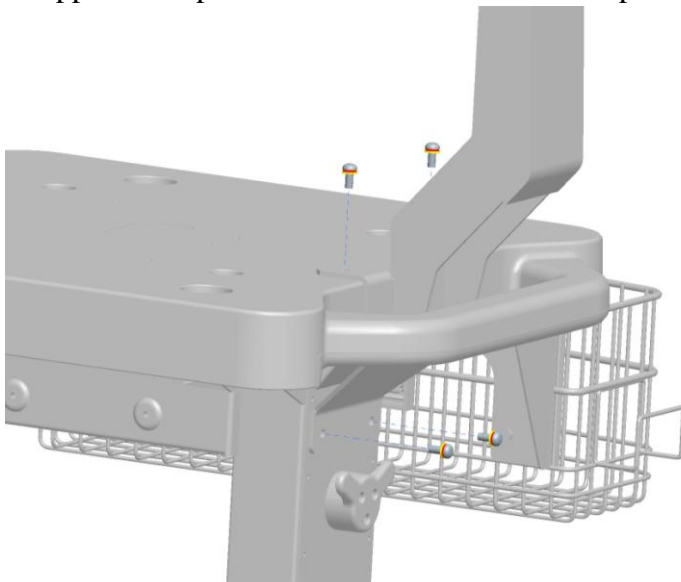

2. Fix the FTS-3 base station on the top of the support bracket with four M3X10 screws.



3. Glue the two cable clamps respectively on the back of the two extremities of the support bracket.
4. Arrange the cables of the base station and fix them with the cable clamps.

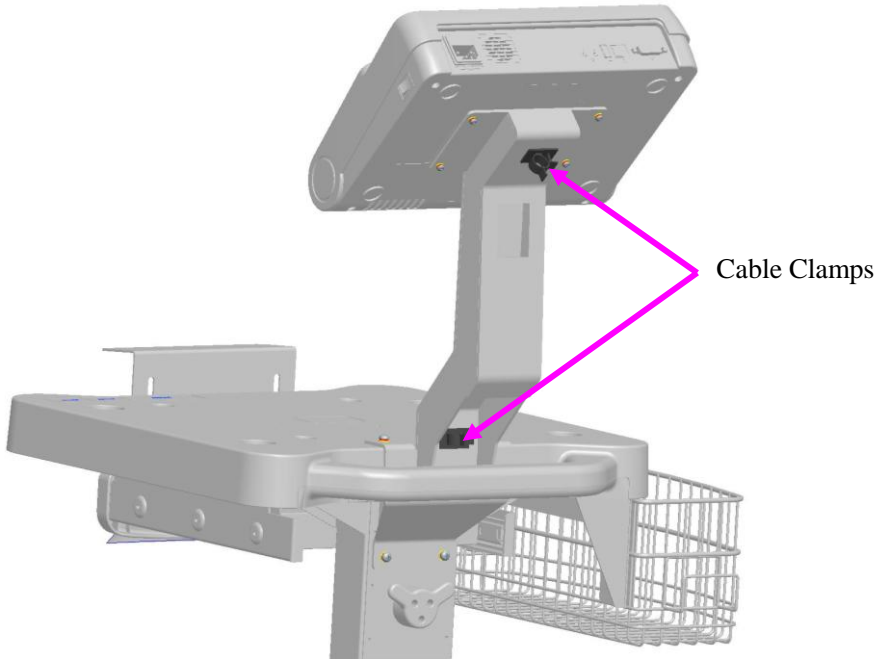

Note:

1. The support bracket and the FTS-3 base station are installed. Check and make sure that they are properly fixed.
2. The support bracket can only be used to support the FTS-3 base station.

Manufactured for

CooperSurgical

95 Corporate Drive

Trumbull, CT 06611 USA

Phone: (800) 243-2974

Fax: (800) 262-0105

www.coopersurgical.com



Edan Instruments, Inc

#15 Jinhui Road, Jinsha Community, Kengzi Sub-District, Pingshan District,
518122 Shenzhen, P.R. China

Shanghai International Holding Corp. GmbH (Europe)

Eiffestraße 80, D-20537 Hamburg Germany

Tel: +49-40-2513175 Fax: +49-40-255726

